

Tree Categories

Trees are categorised in accordance with the cascade chart in Table 1 of the British Standard BS 5837:2005 'Trees in relation to construction - Recommendations'

- Category 'U' - Trees in such condition that they cannot realistically be retained as living trees in context of the current land use for longer than 10 years.
- Category 'A' - Trees of high quality with an estimated remaining life expectancy of at least 40 years.
- Category 'B' - Trees of moderate quality with an estimated remaining life expectancy of at least 20 years.
- Category 'C' - Trees of low quality with an estimated remaining life expectancy of at least 10 years, or young trees with a stem diameter below 150mm.

Root Protection Area

In order to avoid damage to the roots or rooting environment of retained trees, the Root Protection Areas (RPAs) should be plotted around each of the category 'A', 'B' and 'C' trees. This is a minimum area in m² which should be left undisturbed around each retained tree.

The RPA is calculated using the British Standard BS 5837:2012 'Trees in relation to design, demolition and construction - Recommendations'.

The calculated RPA is capped to 707m², which is the equivalent to a circle with a radius of 15m. Where there appears to be restrictions to root growth the root protection area is reshaped to more accurately reflect the likely distribution of the roots.

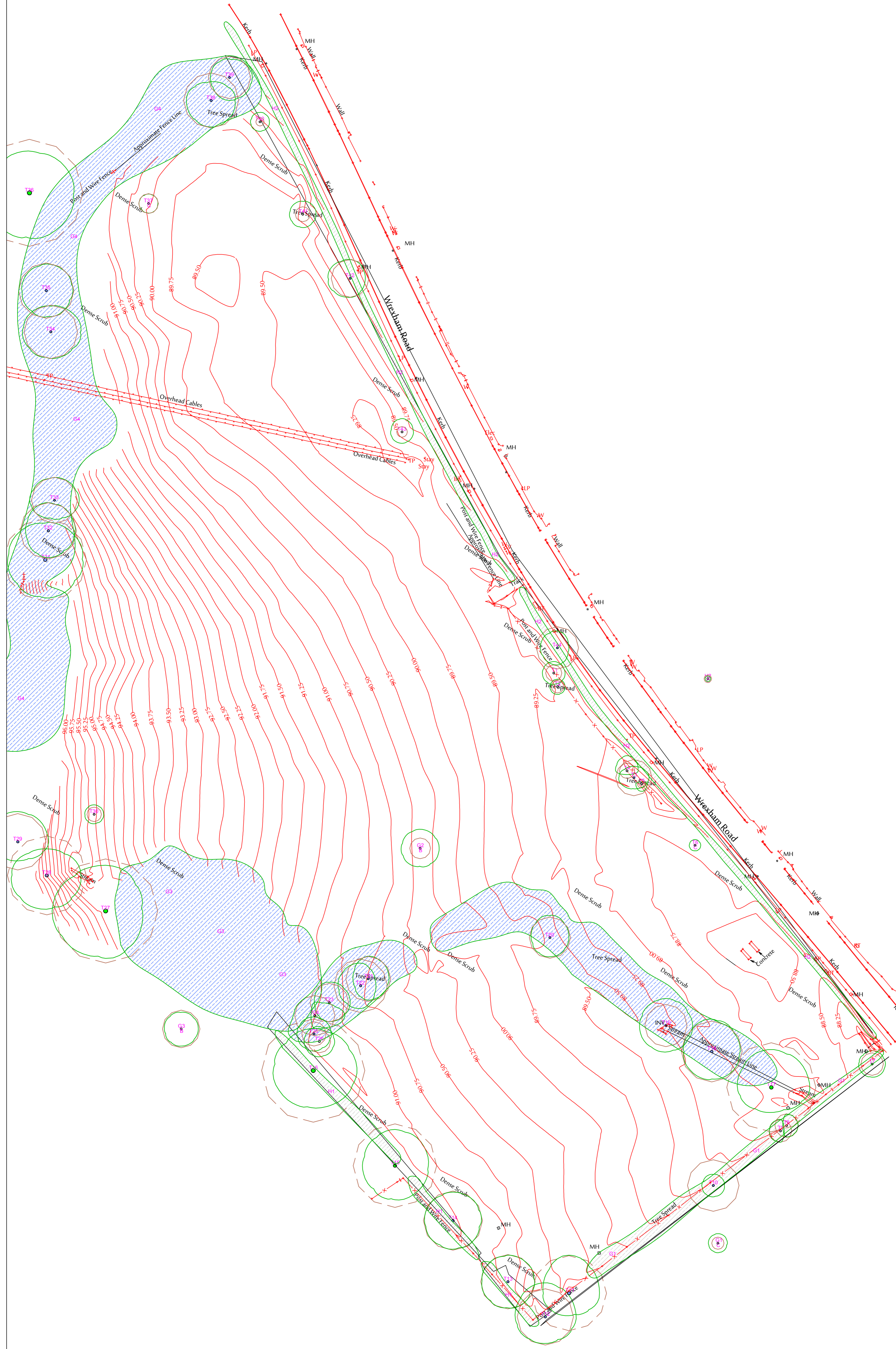

Project: Land at Wrexham Road, Abermorddu, Wrexham, Flintshire

Client: Fisher German LLP

Drawing: Tree Constraints Plan

Based on: Abermorddu 2D

Drawing No: Arbtech TCP 01

Date: Jul 2016 Scale: 1:500 @ A1 Drawn: AST

Key:					
Tree Nos.:	T1	Tree Canopies:		Trunks:	
RPAs:		Category 'A' trees:		Category 'B' trees:	
Category 'C' trees:					

All dimensions should be checked on site. No dimensions are to be taken from this drawing. Please notify us of any discrepancies found. Arbtech Consulting Ltd. cannot be held responsible for inaccuracies in the base drawing on which this plan is based. This drawing is designed to reflect the principles of the layout or design only, and relates only to the protection of retained trees. This drawing is not to be read as a definitive part of the engineering or construction design or method statements. An architect or structural engineer should be consulted over any matters of construction, detailing or specification and for any standards or regulatory requirements relating to proposed structures, hard surfacing or underground services. This drawing was produced in colour - a monochrome copy should not be relied upon. © Arbtech Consulting Ltd. 2016